

Normally Closed

Features

- Classic pilot piston structure , high pressure , using safety;
- Class H coil , support high temperature , with IP65 coils;
- Using good PTEF meets the need of different fluids;

Media: water, hot water, air, oil<20CST etc.

Temperature: FKM:-10~150°C

Pressure: 0-16bar

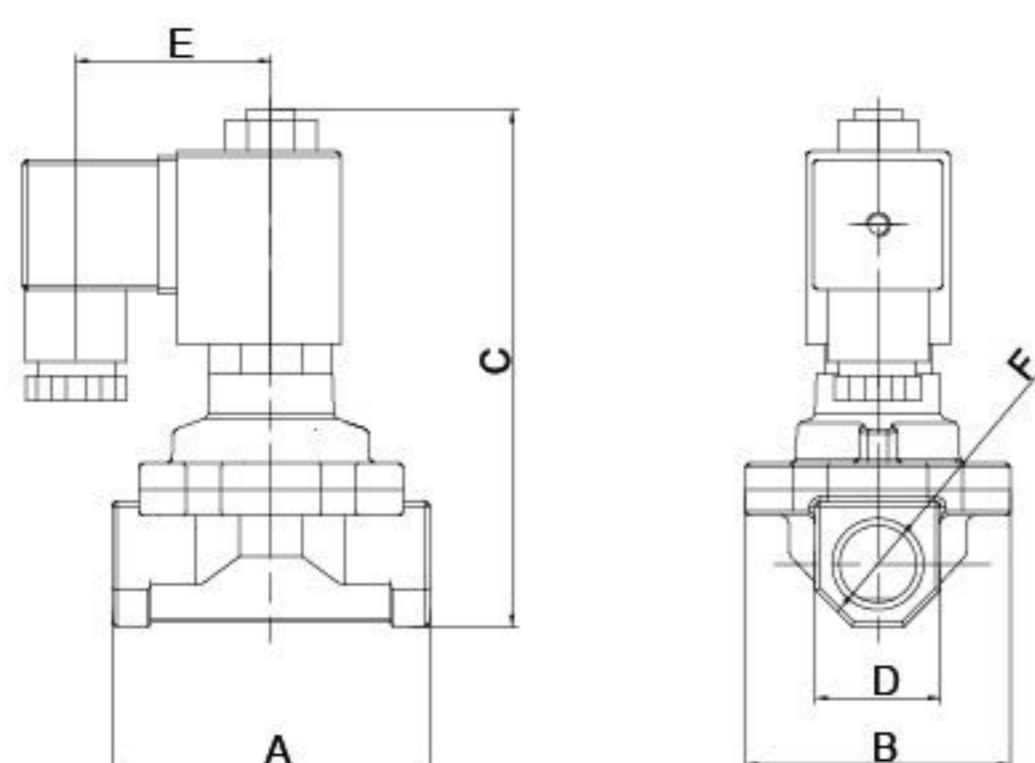

Model	A	B	C	D	E	F	G	H
ZX40-15	67	55	110	26.5	40	1/2"		
ZX40-20	71	55	115	32.5	40	3/4"		
ZX40-25	95	77	121	42.5	40	1"		

Specifications

Model Number (220VAC 50/60Hz)	Connection	Orifice mm	CV Value	Operation ΔP (bar)						Max. Temp. °C	Coil		Power		Size AxBxH	Weight KG		
				Min.	Max.						F	VA	W					
					Air		Water		Oil ≤20CST					AC 220V			DC 24V	
					AC	DC	AC	DC	AC									DC
ZX401DF01V1C15	3/8"	15	4.5	0	16	10	16	10	16	10	150	D	33	32	75x25x129	1.25		
16					10	16	10	16	10	180	W	30	25	75x25x129	1.25			
ZX401DF01V1D15	1/2"	15	4.5	0	16	10	16	10	16	10	150	D	33	32	75x25x129	1.2		
16					10	16	10	16	10	180	W	30	25	75x25x129	1.2			
ZX401DF01V1E20	3/4"	20	9.0	0	16	10	16	10	16	10	150	D	33	32	85x60x141	1.5		
16					10	16	10	16	10	180	W	30	25	85x60x141	1.5			
ZX401DF01V1G25	1"	25	13	0	16	10	16	10	16	10	150	D	33	32	100x70x148	1.9		
16					10	16	10	16	10	180	W	30	25	100x70x148	1.9			

Features

- Classic pilot piston structure , high pressure , using safety;
- Class H coil, support high temperature, with IP65 coils;
- Using good PTEF meets the need of different fluids;

Media: water, hot water, air, oil<20CST etc.

Temperature: FKM:-10~150°C

Pressure: 0-16bar



Specifications

Model Number (220VAC 50/60Hz)	Connection	Orifice mm	CV Value	Operation ΔP (bar)							Max. Temp. °C	Coil		Power		Size AxBxH	Weight KG	
				Min.	Max.							F	VA	W				
					Air		Water		Oil ≤20CST						AC 220V			DC 24V
					AC	DC	AC	DC	AC	DC								
ZX401DF01V2C15	3/8"	15	4.5	0	16	10	16	10	16	10	150	D	33	32	75x25x129	1.25		
ZX401DF01T2C15					180	W	30	25	75x25x129	1.25								
ZX401DF01V2D15	1/2"	15	4.5	0	16	10	16	10	16	10	150	D	33	32	75x25x129	1.2		
ZX401DF01T2D15					180	W	30	25	75x25x129	1.2								
ZX401DF01V2E20	3/4"	20	9.0	0	16	10	16	10	16	10	150	D	33	32	85x60x141	1.5		
ZX401DF01T2E20					180	W	30	25	85x60x141	1.5								
ZX401DF01V2G25	1"	25	13	0	16	10	16	10	16	10	150	D	33	32	100x70x148	1.9		
ZX401DF01T2G25					180	W	30	25	100x70x148	1.9								

Normally Open

Features

- Classic pilot piston structure , high pressure, using safety;
- Class H coil , support high temperature, with IP65 coils;
- Using good PTEF meets the need of different fluids;

Media: water, hot water, air, oil<20CST etc.

Temperature: FKM:-10~150°C

Pressure: 0-10bar



Specifications

Model Number (220VAC 50/60Hz)	Connection	Orifice mm	CV Value	Operation ΔP (bar)							Max. Temp. °C	Coil		Power		Size AxBxH	Weight KG	
				Min.	Max.							F	VA	W				
					Air		Water		Oil ≤20CST						AC 220V			DC 24V
					AC	DC	AC	DC	AC	DC								
ZX402DF01V1C15	3/8"	15	4.5	0	16	10	16	10	16	10	150	D	33	32	75x25x129	1.25		
ZX402DF01T1C15					16	10	16	10	16	10	180	W	30	25	75x25x129	1.25		
ZX402DF01V1D15	1/2"	15	4.5	0	16	10	16	10	16	10	150	D	33	32	75x25x129	1.2		
ZX402DF01T1D15					16	10	16	10	16	10	180	W	30	25	75x25x129	1.2		
ZX402DF01V1E20	3/4"	20	9.0	0	16	10	16	10	16	10	150	D	33	32	85x60x141	1.5		
ZX402DF01T1E20					16	10	16	10	16	10	180	W	30	25	85x60x141	1.5		
ZX402DF01V1G25	1"	25	13	0	16	10	16	10	16	10	150	D	33	32	100x70x148	1.9		
ZX402DF01T1G25					16	10	16	10	16	10	180	W	30	25	100x70x148	1.9		

Features

- Classic pilot piston structure , high pressure, using safety;
- Class H coil, support high temperature, with IP65 coils;
- Using good PTEF meets the need of different fluids;

Media: water, hot water, air, oil<20CST etc.

Temperature: FKM:-10~150°C

Pressure: 0-10bar



Specifications

Model Number (220VAC 50/60Hz)	Connection	Orifice mm	CV Value	Operation ΔP (bar)								Max. Temp. °C	Coil		Power		Size AxBxH	Weight KG
				Min.	Max.						F		VA AC 220V	W DC 24V				
					Air		Water		Oil ≤20CST									
					AC	DC	AC	DC	AC	DC								
ZX402DF01V2C15 ZX402DF01T2C15	3/8"	15	4.5	0	16	10	16	10	16	10	150	D	33	32	75x25x129	1.25		
180					W	30	25	75x25x129	1.25									
ZX402DF01V2D15 ZX402DF01T2D15	1/2"	15	4.5	0	16	10	16	10	16	10	150	D	33	32	75x25x129	1.2		
180					W	30	25	75x25x129	1.2									
ZX402DF01V2E20 ZX402DF01T2E20	3/4"	20	9.0	0	16	10	16	10	16	10	150	D	33	32	85x60x141	1.5		
180					W	30	25	85x60x141	1.5									
ZX402DF01V2G25 ZX402DF01T2G25	1"	25	13	0	16	10	16	10	16	10	150	D	33	32	100x70x148	1.9		
180					W	30	25	100x70x148	1.9									